

INSTALLATION INSTRUCTIONS

DESCRIPTION: **Glide Plate Kit**
PART NUMBER: **2BS-F84R0-V0-00**
MODEL: **XTZ1200 (Super Ténéré)**



WARNING

Please read and understand these instructions completely before installation to avoid possible injury, or damage to the accessory or vehicle.

NOTICE:

This installation requires a torque wrench and should be performed by an authorized Yamaha or other qualified technician.

WARRANTY INFORMATION:

Genuine Yamaha accessories are covered by a one-year limited warranty against defects in material or workmanship. Labor for replacement of defective components is not covered. See your Yamaha dealer for a copy of the warranty statement.

DEALER OR INSTALLER:

These instructions contain important information for future reference and must be given to the

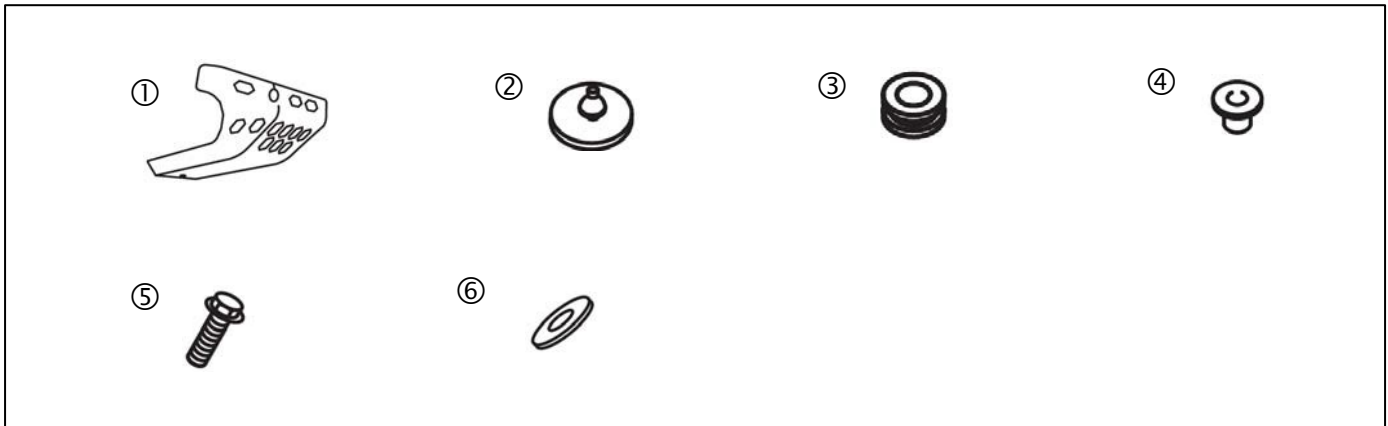

PARTS LIST:

Item	Part Number	Description	Qty
--	2BS-F84R0-V0	Glide Plate Kit	--
①	*	Glide Plate	1
②	*	Plastic Bumper	2
③	*	Grommet	1
④	*	Collar	1
⑤	*	Bolt (M6 x 20mm)	1
⑥	*	Washer	1

* Part supplied with kit only and not available separately.

Fig. 1

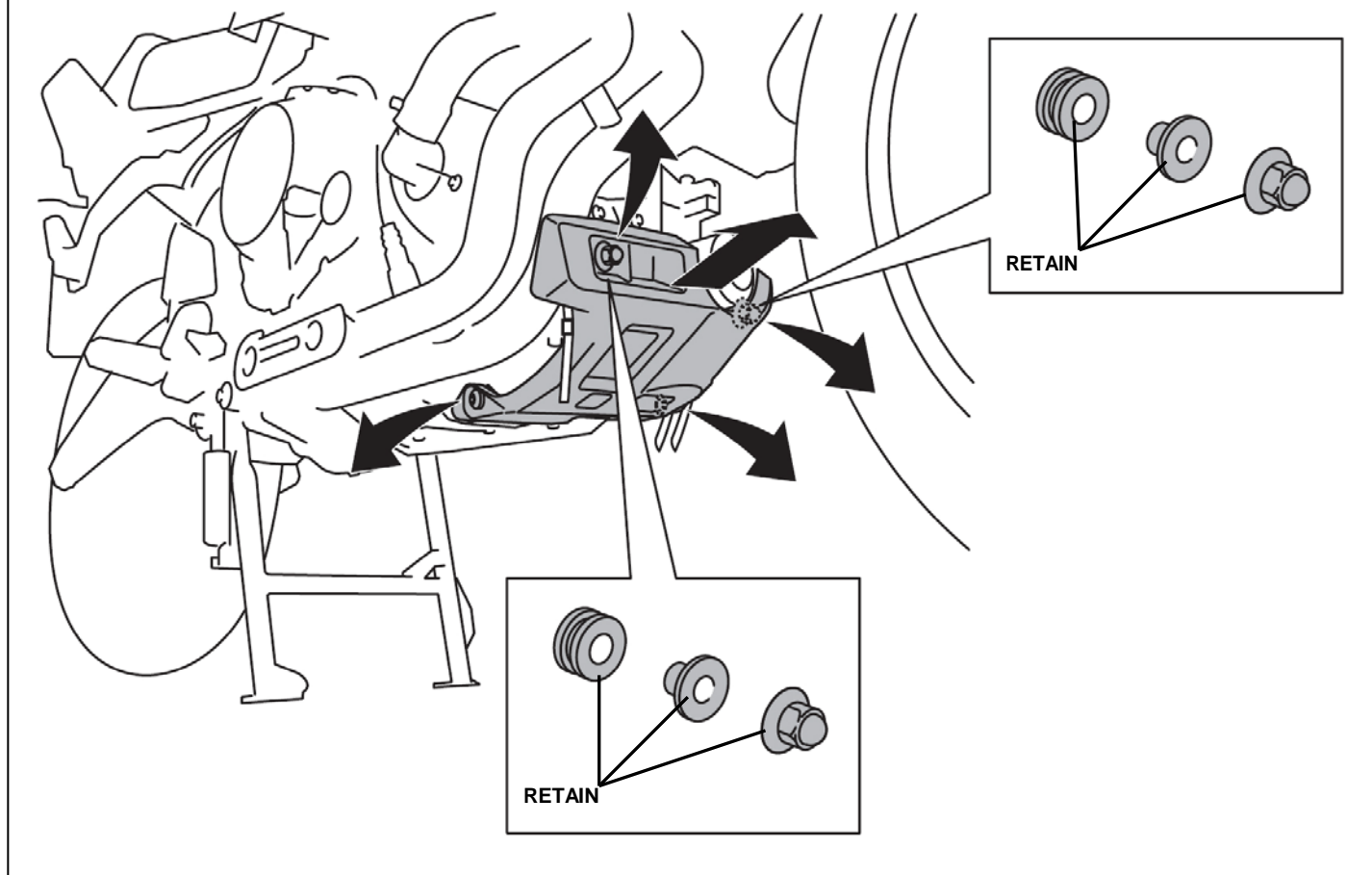

PREPARATION:

1. Place motorcycle on a secure and level surface.
2. Clean all mounting surfaces before beginning installation.
3. Place the motorcycle on a rear stand or the main stand before proceeding with the installation.

⚠WARNING

Failure to secure the motorcycle properly may result in possible injury to yourself or damage to the accessory or vehicle.

INSTALLATION:

1. Remove the stock glide plate. Retain all hardware shown in Figure 1 as it will be reused.

Fig. 2

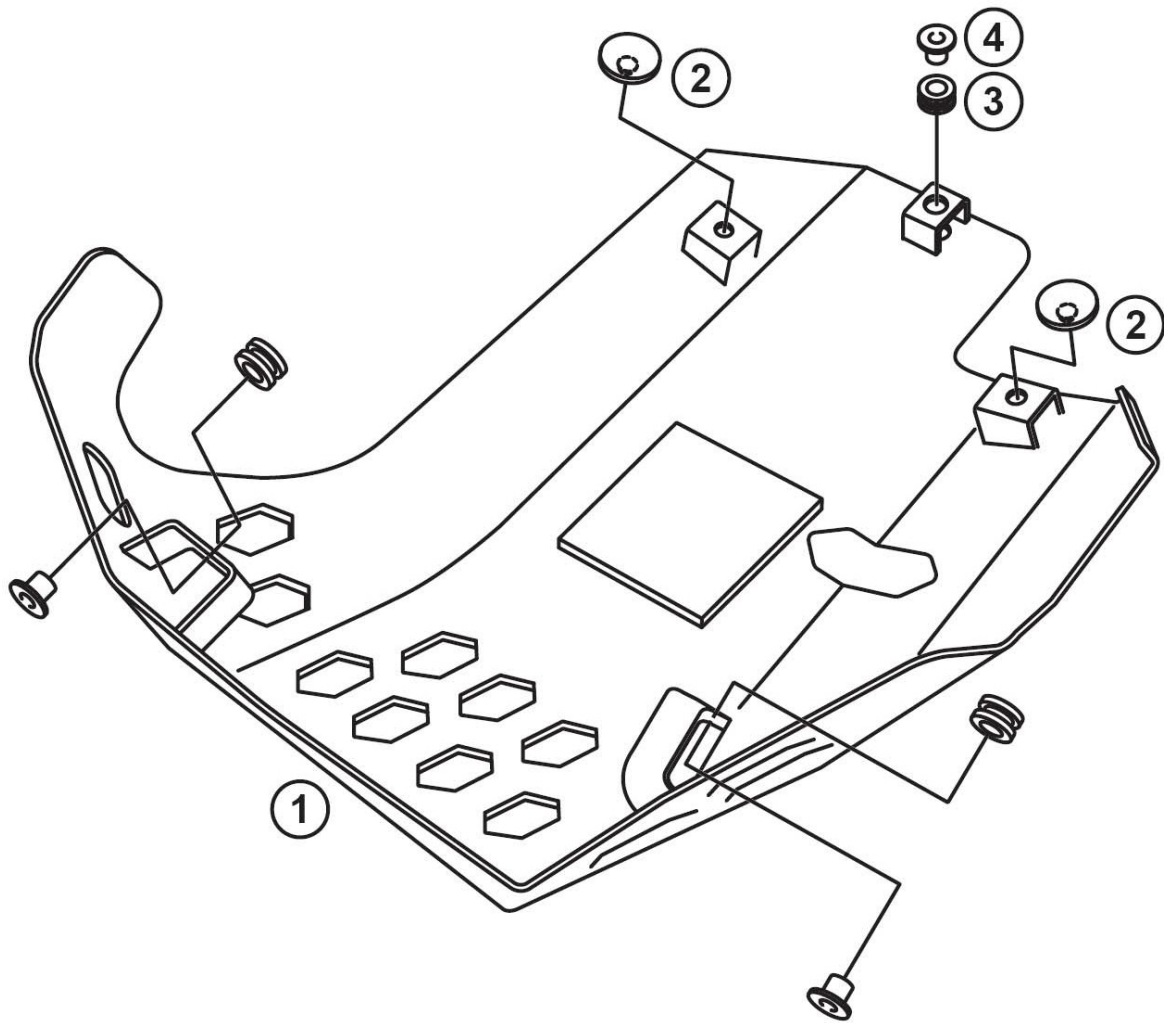

2. Install the original collars and grommets onto the glide plate ① as shown in Figure 2.
3. Install the plastic bumper ② onto the glide plate ① as shown in Figure 2.
4. Install the supplied collar ④ and grommet ③ onto the glide plate as shown in Figure 2.

Fig. 3

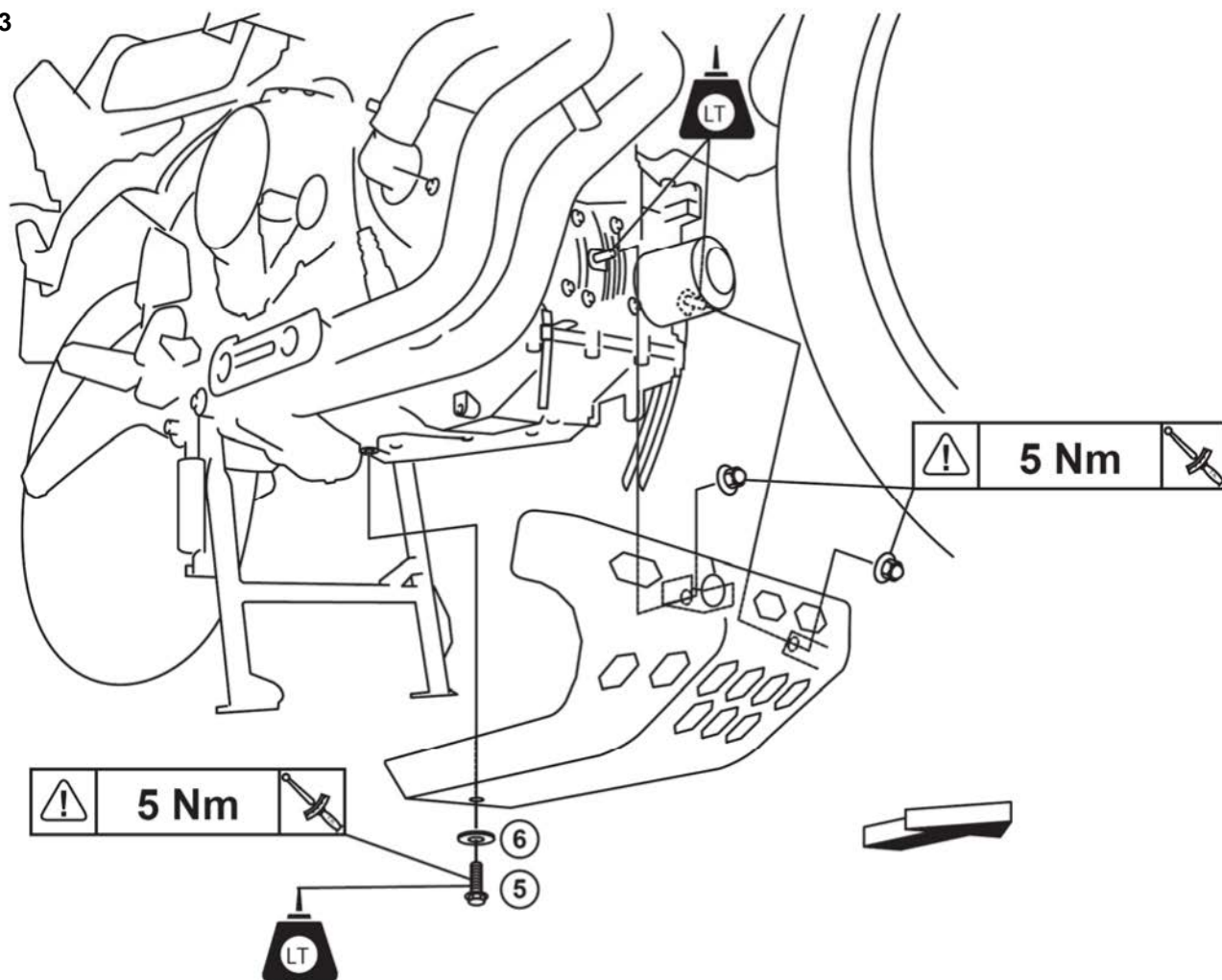

NOTE:



Apply Loctite[®] 242 to the flange head bolt ⑤ and the threaded inserts on the engine block (Fig. 3).

5. Install the glide plate ① onto the studs on the engine case and use the original acorn nuts to secure in place (Fig. 3).
6. Torque the acorn nuts to 5 Nm (3.7 ft • lb).
7. Secure the lower mounting location using the flange head bolt ⑤ and the washer ⑥ (Fig. 3).
8. Torque the flange head bolts ⑤ to 5 Nm (3.7 ft • lb)

MAINTENANCE:

Periodically, check torque on all hardware. If loose hardware is found, remove hardware, clean off old Loctite[®], re-apply fresh Loctite[®], and re-torque to specification.

CARE AND CLEANING:

Wash using mild soap and water.

CUSTOMER SERVICE:

For further information, see your Yamaha dealer.

ESTIMATED TIME TO INSTALL: 0.3 HRS